

**Gleitlager-Winkel-Drehgelenk Typ GWD / Swivel banjo coupling**  
Metrisches Außengewinde mit 24°-Innenkonus. BSP-Einschraubgewinde (zylindrisch, Form E).  
Male thread 24°. BSP-thread cylindric, form E.

Art. Nr. Art. N°	Bezeichnung Description	Standard	R1	G1	G2	L1 (mm)	WP (bar)
277.500	GWD L06 /G1/8"	•	L06	M12x1,5	G1/8"	21	250
277.501	GWD L06 /G1/4"		L06	M12x1,5	G1/4"	22	250
277.505	GWD L08 /G1/4"	•	L08	M14x1,5	G1/4"	25	250
277.510	GWD L10 /G1/4"	•	L10	M16x1,5	G1/4"	25	250
277.511	GWD L10 /G3/8"		L10	M16x1,5	G3/8"	27	250
277.515	GWD L12 /G3/8"	•	L12	M18x1,5	G3/8"	27	250
277.516	GWD L12 /G1/2"		L12	M18x1,5	G1/2"	30	250
277.520	GWD L15 /G1/2"	•	L15	M22x1,5	G1/2"	33	250
277.525	GWD L18 /G1/2"	•	L18	M26x1,5	G1/2"	33	160
277.530	GWD L22 /G3/4"	•	L22	M30x2	G3/4"	35	160
277.535	GWD L28 /G1"	•	L28	M36x2	G1"	41	100
277.540	GWD L35 /G1.1/4"	•	L35	M45x2	G1.1/4"	51	100
277.545	GWD L42 /G1.1/2"	•	L42	M52x2	G1.1/2"	56	100
277.550	GWD S06 /G1/4"	•	S06	M14x1,5	G1/4"	22	400
277.555	GWD S08 /G1/4"	•	S08	M16x1,5	G1/4"	22	400
277.560	GWD S10 /G3/8"	•	S10	M18x1,5	G3/8"	25	400
277.565	GWD S12 /G3/8"	•	S12	M20x1,5	G3/8"	27	400
277.570	GWD S14 /G1/2"	•	S14	M22x1,5	G1/2"	30	400
277.575	GWD S16 /G1/2"	•	S16	M24x1,5	G1/2"	33	400
277.580	GWD S20 /G3/4"	•	S20	M30x2	G3/4"	35	250
277.585	GWD S25 /G1"	•	S25	M36x2	G1"	41	250
277.590	GWD S30 /G1.1/4"	•	S30	M42x2	G1.1/4"	51	250
277.595	GWD S38 /G1.1/2"	•	S38	M52x2	G1.1/2"	56	250

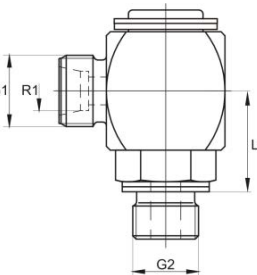

<b>Gleitlager-Winkel-Drehelenk Typ GWD / Swivel banjo coupling</b>							
Metrisches Außengewinde mit 24°-Innenkonus. Metrisches Einschraubgewinde (zylindrisch, ED). Male thread 24°. Metric-thread cylindric, form E.							
Art. Nr.	Bezeichnung	Standard	R1	G1	G2	L1 (mm)	WP (bar)
Art. N°	Description						
277.600	GWD L06 /M10x1	•	L06	M12x1,5	M10x1	21	250
277.601	GWD L06 /M12x1,5		L06	M12x1,5	M12x1,5	22	250
277.605	GWD L08 /M12x1,5	•	L08	M14x1,5	M12x1,5	22	250
277.606	GWD L08 /M14x1,5		L08	M14x1,5	M14x1,5	25	250
277.610	GWD L10 /M14x1,5	•	L10	M16x1,5	M14x1,5	25	250
277.611	GWD L10 /M16x1,5		L10	M16x1,5	M16x1,5	27	250
277.615	GWD L12 /M16x1,5	•	L12	M18x1,5	M16x1,5	27	250
277.616	GWD L12 /M18x1,5		L12	M18x1,5	M18x1,5	30	250
277.620	GWD L15 /M18x1,5	•	L15	M22x1,5	M18x1,5	30	250
277.621	GWD L15 /M22x1,5		L15	M22x1,5	M22x1,5	33	250
277.625	GWD L18 /M22x1,5	•	L18	M26x1,5	M22x1,5	33	160
277.630	GWD L22 /M26x1,5	•	L22	M30x2	M26x1,5	35	160
277.635	GWD L28 /M33x2	•	L28	M36x2	M33x2	41	100
277.640	GWD L35 /M42x2	•	L35	M45x2	M42x2	50	100
277.645	GWD L42 /M48x2	•	L42	M52x2	M48x2	56	100
277.650	GWD S06 /M12x1,5	•	S06	M14x1,5	M12x1,5	22	400
277.655	GWD S08 /M14x1,5	•	S08	M16x1,5	M14x1,5	22	400
277.660	GWD S10 /M16x1,5	•	S10	M18x1,5	M16x1,5	25	400
277.665	GWD S12 /M18x1,5	•	S12	M20x1,5	M18x1,5	27	400
277.670	GWD S14 /M20x1,5	•	S14	M22x1,5	M20x1,5	30	400
277.675	GWD S16 /M22x1,5	•	S16	M24x1,5	M22x1,5	33	400
277.680	GWD S20 /M27x2	•	S20	M30x2	M27x2	35	250
277.685	GWD S25 /M33x2	•	S25	M36x2	M33x2	41	250
277.690	GWD S30 /M42x2	•	S30	M42x2	M42x2	51	250
277.695	GWD S38 /M48x2	•	S38	M52x2	M48x2	56	250

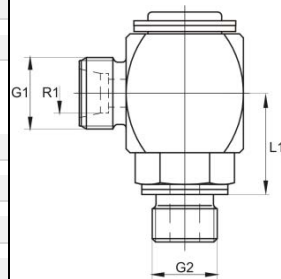

**Standard** Standardgröße / Standard size  
**R1** Rohrgröße / Pipe size  
**G1** Gewinde / Thread  
**G2** Gewinde / Thread  
**L1 (mm)** Länge / Length  
**WP (bar)** Betriebsdruck / Working pressure



<b>Kugellager-Winkel-Drehgelenk Typ KWD.. /</b>								
Metrisches Außengewinde mit 24°-Innenkonus. BSP-Einschraubgewinde (zylindrisch, Form E).								
Male thread 24°. BSP-thread cylindric, form E.								
Art. Nr.	Bezeichnung	Standard	R1	G1	G2	L1	WP	
Art. N°	Description					(mm)	(bar)	
277.700	KWD L06 /G1/8"	•	L06	M12x1,5	G1/8"	41	315	
277.701	KWD L06 /G1/4"		L06	M12x1,5	G1/4"	41	315	
277.705	KWD L08 /G1/4"	•	L08	M14x1,5	G1/4"	41	315	
277.710	KWD L10 /G1/4"	•	L10	M16x1,5	G1/4"	41	315	
277.711	KWD L10 /G3/8"		L10	M16x1,5	G3/8"	51	315	
277.715	KWD L12 /G3/8"	•	L12	M18x1,5	G3/8"	51	315	
277.716	KWD L12 /G1/2"		L12	M18x1,5	G1/2"	50	315	
277.720	KWD L15 /G1/2"	•	L15	M22x1,5	G1/2"	50	315	
277.725	KWD L18 /G1/2"	•	L18	M26x1,5	G1/2"	50	315	
277.730	KWD L22 /G3/4"	•	L22	M30x2	G3/4"	66	160	
277.735	KWD L28 /G1"	•	L28	M36x2	G1"	64	160	
277.740	KWD L35 /G1.1/4"	•	L35	M45x2	G1.1/4"	80	160	
277.745	KWD L42 /G1.1/2"	•	L42	M52x2	G1.1/2"	81	160	
277.750	KWD S06 /G1/4"	•	S06	M14x1,5	G1/4"	41	500	
277.755	KWD S08 /G1/4"	•	S08	M16x1,5	G1/4"	41	500	
277.760	KWD S10 /G3/8"	•	S10	M18x1,5	G3/8"	41	500	
277.765	KWD S12 /G3/8"	•	S12	M20x1,5	G3/8"	51	500	
277.770	KWD S14 /G1/2"	•	S14	M22x1,5	G1/2"	50	500	
277.775	KWD S16 /G1/2"	•	S16	M24x1,5	G1/2"	50	400	
277.780	KWD S20 /G3/4"	•	S20	M30x2	G3/4"	66	400	
277.785	KWD S25 /G1"	•	S25	M36x2	G1"	64	400	
277.790	KWD S30 /G1.1/4"	•	S30	M42x2	G1.1/4"	80	400	
277.795	KWD S38 /G1.1/2"	•	S38	M52x2	G1.1/2"	81	315	

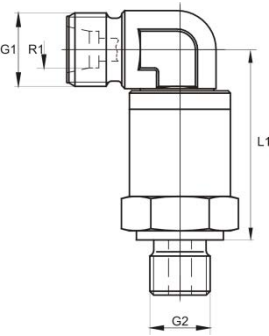

<b>Kugellager-Winkel-Drehgelenk Typ KWD /.. /</b>							
Metrisches Außengewinde mit 24°-Innenkonus. Metrisches Einschraubgewinde (zylindrisch, Form E).							
Male thread 24°. Metric-thread cylindrical, form E.							
Art. Nr.	Bezeichnung	Standard	R1	G1	G2	L1 (mm)	WP (bar)
Art. N°	Description						
277.800	KWD L06 /M10x1	•	L06	M12x1,5	M10x1	41	315
277.801	KWD L06 /M12x1,5		L06	M12x1,5	M12x1,5	42	315
277.805	KWD L08 /M12x1,5	•	L08	M14x1,5	M12x1,5	42	315
277.806	KWD L08 /M14x1,5		L08	M14x1,5	M12x1,5	41	315
277.810	KWD L10 /M14x1,5	•	L10	M16x1,5	M14x1,5	41	315
277.811	KWD L10 /M16x1,5		L10	M16x1,5	M16x1,5	51	315
277.815	KWD L12 /M16x1,5	•	L12	M18x1,5	M16x1,5	51	315
277.816	KWD L12 /M18x1,5		L12	M18x1,5	M18x1,5	51	315
277.820	KWD L15 /M18x1,5	•	L15	M22x1,5	M18x1,5	51	315
277.825	KWD L18 /M22x1,5	•	L18	M26x1,5	M22x1,5	50	315
277.830	KWD L22 /M26x1,5	•	L22	M30x2	M26x1,5	65	160
277.835	KWD L28 /M33x2	•	L28	M36x2	M33x2	64	160
277.840	KWD L35 /M42x2	•	L35	M45x2	M42x2	80	160
277.845	KWD L42 /M48x2	•	L42	M52x2	M48x2	80	160
277.850	KWD S06 /M12x1,5	•	S06	M14x1,5	M12x1,5	42	500
277.855	KWD S08 /M14x1,5	•	S08	M16x1,5	M14x1,5	41	500
277.860	KWD S10 /M16x1,5	•	S10	M18x1,5	M16x1,5	41	500
277.865	KWD S12 /M18x1,5	•	S12	M20x1,5	M18x1,5	51	500
277.870	KWD S14 /M20x1,5	•	S14	M22x1,4	M20x1,5	50	500
277.875	KWD S16 /M22x1,5	•	S16	M24x1,5	M22x1,5	50	400
277.880	KWD S20 /M27x2	•	S20	M30x2	M27x2	66	400
277.885	KWD S25 /M33x2	•	S25	M36x2	M33x2	64	400
277.890	KWD S30 /M42x2	•	S30	M42x2	M42x2	80	400
277.895	KWD S38 /M48x2	•	S38	M52x2	M48x2	80	315

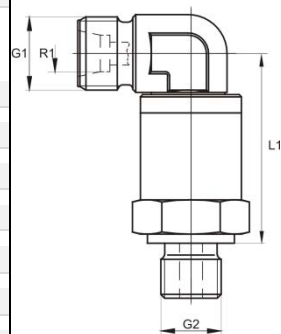

**Standard** Standardgröße / Standard size  
**R1** Rohrgröße / Pipe size  
**G1** Gewinde / Thread  
**G2** Gewinde / Thread  
**L1 (mm)** Länge / Length  
**WP (bar)** Betriebsdruck / Working pressure